

1ST CHOICE

HOT WATER

1300 726 211



BOSCH

Invented for life

Bosch Product Reference Guide

bosch-climate.com.au

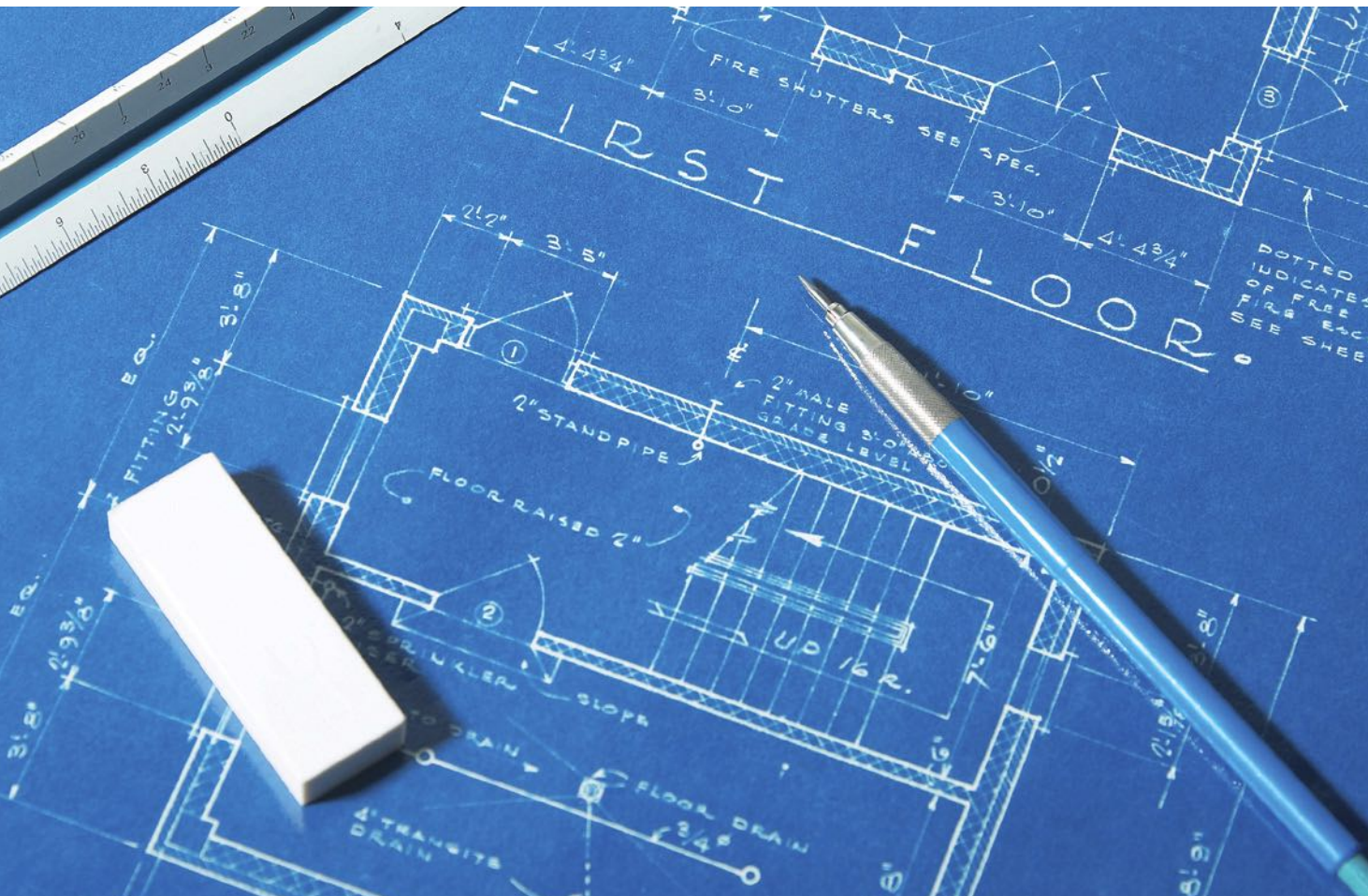

Contents

OptiFlow	3
Bosch Water & ProWater Apps	4
OptiFlow Professional 12L	5
OptiFlow Professional 16-26L	6
OptiFlow Accessories	7
OptiFlow Professional Internal	8
OptiFlow Accessories	9
Selecting the right flue	10
Highflow Condensing	14
Highflow Condensing Accessories	15
HydroPower	16
Pilot	17
Internal Compact	18
Compress 3000	19
Warranty & Service Information	21
Bosch e-Learning Program	22



Features & Benefits

- ▶ OptiFlow combustion management system
- ▶ Bluetooth enabled appliance*
- ▶ Compatible with Bosch Water and ProWater apps
- ▶ 6 star efficiency
- ▶ Compact, lightweight
- ▶ Solar compatible water heater
- ▶ Electronically controlled modulation
- ▶ Up to 3 controllers can be installed in addition to the Bluetooth controller
- ▶ 50°C compliant models available
- ▶ 3 year parts and labour warranty
- ▶ 12 year heat exchanger warranty (part only)



Specifications		Model		
	Unit	16L	20L	26L
Technical features				
Bluetooth Enabled Appliance		Yes - Up to 10m range*		
Star Rating		6 Stars		
Solar Compatible		Yes		
Temperature Controllers		Up to 3 temperature controllers plus the Bosch OptiFlow App can be installed		
Maximum Temperature		Preset at 55°C. Adjustable to 60°C and 70°C		
50°C compliant models available		Yes		
Weight (unpacked)	kg	15	15	18
Frost protection included		Yes		
Gas supply data				
Max. Nominal Gas Consumption	Mj/h	122	149	199
Minimum Gas Supply Pressure - NG (in operation)	kPa	1.13		
Minimum Gas Supply Pressure - LPG (in operation)	kPa	2.75		
Water Supply Data				
Maximum Permissible Pressure (static)	kPa	1000		
Minimum Operating Pressure	kPa	100		
Minimum Operating Pressure for Max. Performance	kPa	300		
Minimum Water Flow	l/min	2		
L/min at 25°C Temperature Rise	l/min	16	20	26
Maximum Inlet Temperature	°C	80		
Electrical Circuit				
Power Supply Voltage	Vac	230/240		
Frequency	Hz	50		
Warranty Details (Domestic)				
Parts and Labour	Years	3		
Heat Exchanger (part only)	Years	12		
Pipe Connection Sizes				
Gas Connection - NG or LPG	mm	20mm		
Cold Water	mm	20mm		
Hot Water	mm	20mm		

* The Bluetooth range maybe reduced due to the thickness of building material and density of barriers between the appliance and your smart phone or tablet.

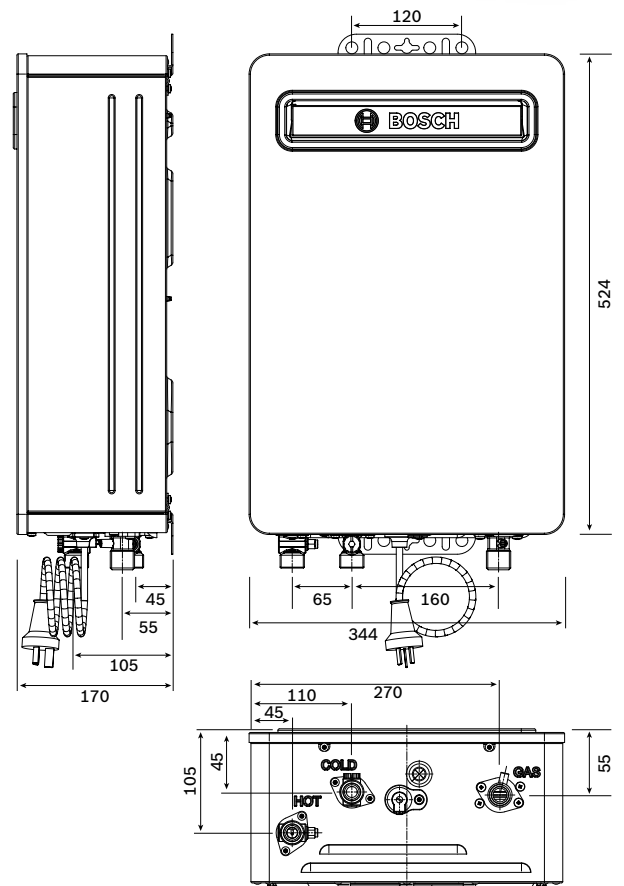

Description	Part Number
OptiFlow 16L NG	7736503241
OptiFlow 16L LPG	7736503242
OptiFlow 16L NG 50°C Compliant	7736503239
OptiFlow 16L LPG 50°C Compliant	7736503240
OptiFlow 20L NG	7736503249
OptiFlow 20L LPG	7736503250
OptiFlow 20L NG 50°C Compliant	7736503247
OptiFlow 20L LPG 50°C Compliant	7736503248
OptiFlow 26L NG	7736503230
OptiFlow 26L LPG	7736503231
OptiFlow 26L NG 50°C Compliant	7736503228
OptiFlow 26L LPG 50°C Compliant	7736503229

Bosch Water & ProWater Apps



FEATURES USER & SERVICE

Bosch have developed Bosch Water and Bosch ProWater apps to provide User and Tradesperson with features that until now have not been available on a water heater. Both Apps connect to OptiFlow Bluetooth enabled appliances from a range of up to 10m from the appliance.

Bosch Water for the User

- ▶ Temperature control
- ▶ Running cost information
- ▶ Energy usage information
- ▶ Water consumption information

Bosch ProWater for Install & Service

- ▶ Real-time performance monitoring
- ▶ Real-time diagnostics
- ▶ Error codes with recommended service procedures
- ▶ Back-up of appliance parameters
- ▶ PLUS all User features

Pairing with Bluetooth

- 1 Download the Bosch Water or ProWater app from the App Store or Play Store.
- 2 Open the app and select: "Search for appliances".
- 3 Identify your appliance using the code located on the app label, located on the base of the appliance.
- 4 Enter the appliance password listed on the app label.
- 5 Enjoy using the Bosch Water app.



Note: Only works with OptiFlow models - not compatible with OptiFlow Professional models



OptiFlow Professional 12L

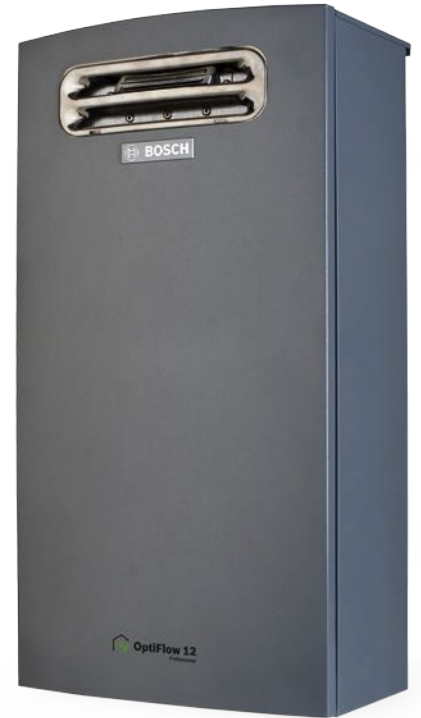

Features & Benefits

- ▶ 6 Star efficiency
- ▶ Electronically controlled modulation
- ▶ Designed for easy change over from HydroPower & Pilot models
- ▶ 12L, low gas load appliance
- ▶ Solar compatible water heater
- ▶ 50°C compliant models available
- ▶ 3 year parts and labour warranty
- ▶ 12 year heat exchanger warranty (part only)

Specifications	Unit	Model 12L
Technical features		
Bluetooth Enabled Appliance		No
Star Rating		6 Stars
Solar Compatible		Yes
Temperature Controllers		1 temperature controller
Maximum Temperature		Preset at 55°C. Adjustable to 60°C and 70°C
50°C compliant models available		Yes
Weight (unpacked)	kg	10
Frost protection included		Yes
Gas supply data		
Maximum Nominal Gas Consumption	Mj/h	90
Minimum Gas Supply Pressure - NG (in operation)	kPa	1.13
Minimum Gas Supply Pressure - LPG (in operation)	kPa	2.75
Water Supply Data		
Maximum Permissible Pressure (static)	kPa	1000
Minimum Operating Pressure	kPa	100
Minimum Operating Pressure for Max. Performance	kPa	200
Minimum Water Flow	l/min	2.2
L/min at 25°C Temperature Rise	l/min	12
Maximum Inlet Temperature	°C	80
Electrical Circuit		
Power Supply Voltage	Vac	230 / 240
Frequency	Hz	50
Maximum Power - Frost Protection	W	165
Maximum Power - Normal Operation	W	48
Warranty Details (Domestic)		
Parts and Labour	Years	3
Heat Exchanger (part only)	Years	12
Pipe Connection Sizes		
Gas Connection - NG or LPG	mm	15mm
Cold Water	mm	15mm
Hot Water	mm	15mm

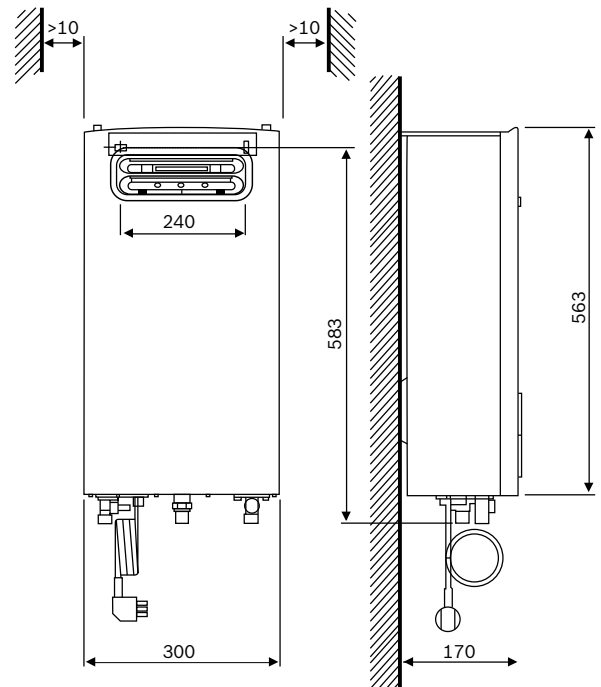

Description	Part Number
OptiFlow Professional Ext 12L NG	7736502491
OptiFlow Professional Ext 12L LPG	7736502492
OptiFlow Professional Ext 12L 50°C compliant NG	7736502493
OptiFlow Professional Ext 12L 50°C compliant LPG	7736502494



OptiFlow Professional 16-26L

Features & Benefits

- ▶ OptiFlow combustion management system
- ▶ 6 star efficiency
- ▶ Compact, lightweight water heater
- ▶ Solar compatible appliance
- ▶ Up to 4 optional controllers
- ▶ Electronically controlled modulation
- ▶ 3 year parts and labour warranty
- ▶ 12 year heat exchanger warranty (part only)
- ▶ 50°C compliant models available

Specifications		Model		
	Unit	16L	20L	26L
Technical features				
Bluetooth Enabled Appliance		No		
Star Rating		6 Stars		
Solar Compatible		Yes		
Temperature Controllers		Up to 4 temperature controllers		
Maximum Temperature		Preset at 55°C. Adjustable to 60°C and 70°C		
50°C compliant models available		Yes		
Weight (unpacked)	kg	15	15	18
Frost protection included		Yes		
Gas supply data				
Maximum Nominal Gas Consumption	Mj/h	122	149	199
Minimum Gas Supply Pressure - NG (in operation)	kPa	1.13		
Minimum Gas Supply Pressure - LPG (in operation)	kPa	2.75		
Water Supply Data				
Maximum Permissible Pressure (static)	kPa	1000		
Minimum Operating Pressure	kPa	100		
Minimum Operating Pressure for Max. Performance	kPa	300		
Minimum Water Flow	l/min	2		
L/min at 25°C Temperature Rise	l/min	16	20	26
Maximum Inlet Temperature	°C	80		
Electrical Circuit				
Power Supply Voltage	Vac	230/240		
Frequency	Hz	50		
Maximum Power - Frost Protection	W	165		
Maximum Power - Normal Operation	W	57	57	70
Warranty Details (Domestic)				
Parts and Labour	Years	3		
Heat Exchanger (part only)	Years	12		
Pipe Connection Sizes				
Gas Connection - NG or LPG	mm	20mm		
Cold Water	mm	20mm		
Hot Water	mm	20mm		

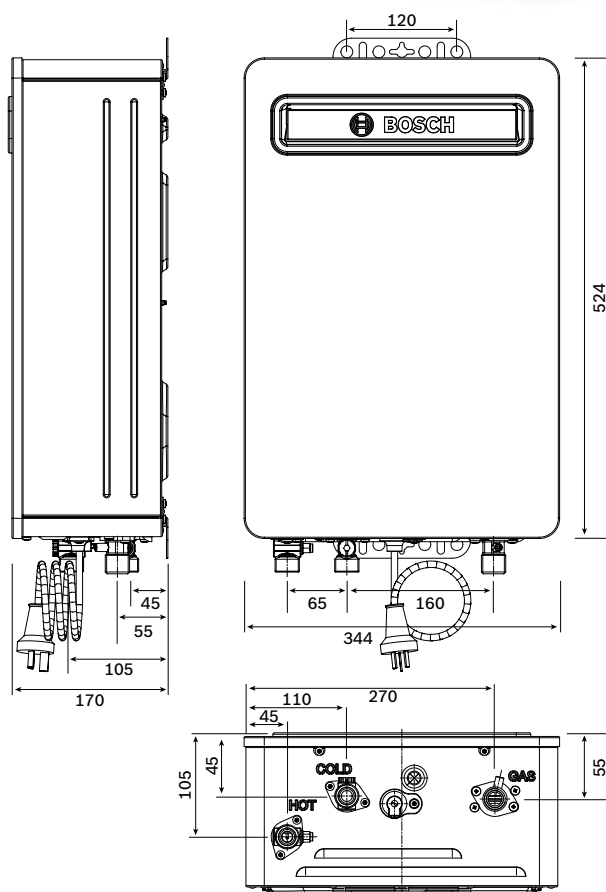

Description	Part Number
OptiFlow Professional 16L NG	7736503237
OptiFlow Professional 16L LPG	7736503238
OptiFlow Professional 16L NG 50°C Compliant	7736503235
OptiFlow Professional 16L LPG 50°C Compliant	7736503236
OptiFlow Professional 20L NG	7736503245
OptiFlow Professional 20L LPG	7736503246
OptiFlow Professional 20L NG 50°C Compliant	7736503243
OptiFlow Professional 20L LPG 50°C Compliant	7736503244
OptiFlow Professional 26L NG	7736503226
OptiFlow Professional 26L LPG	7736503227
OptiFlow Professional 26L NG 50°C Compliant	7736503224
OptiFlow Professional 26L LPG 50°C Compliant	7736503225

OptiFlow Accessories

Recess box – for OptiFlow External 16L, 20L & 26L models

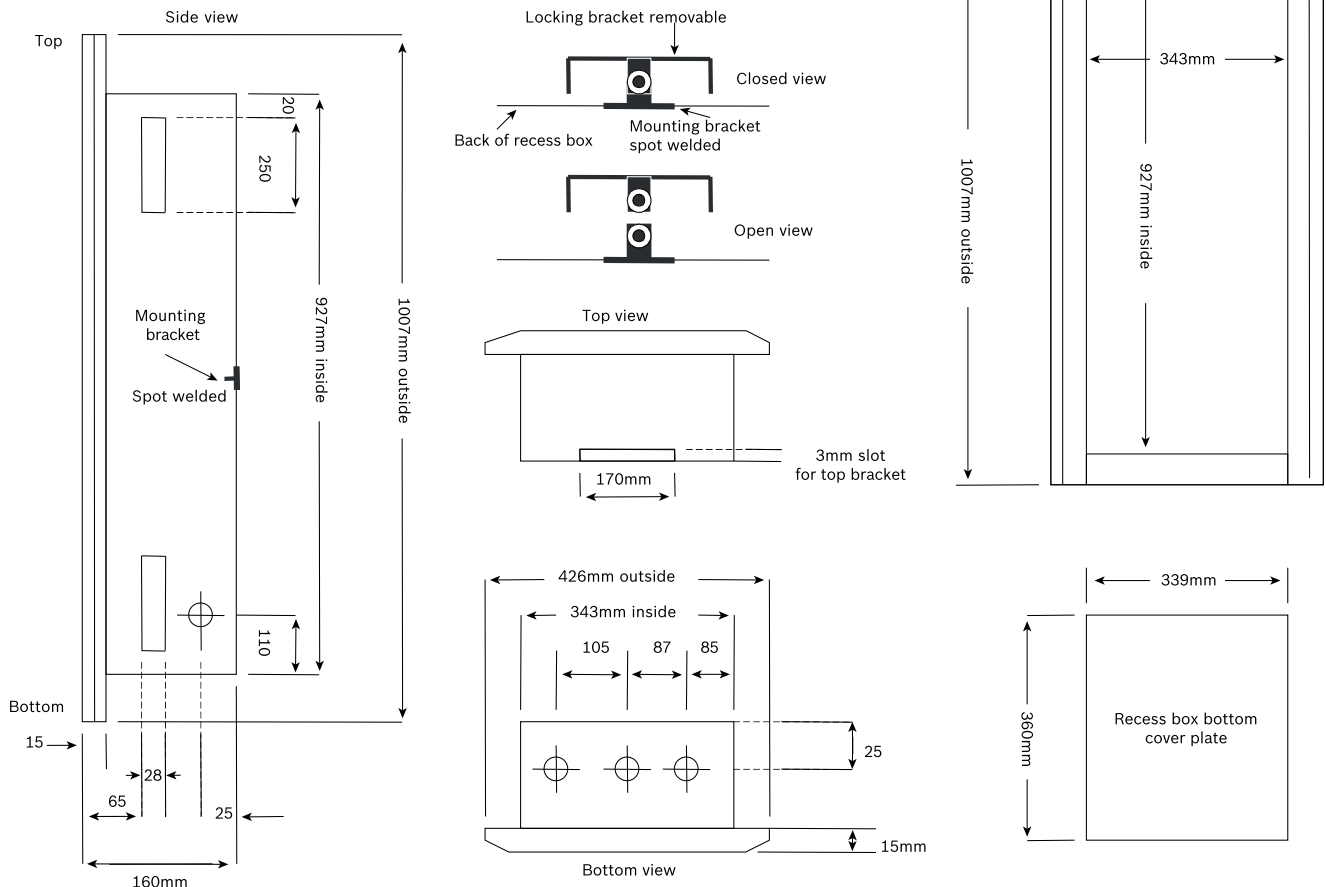

Description	Part Number
Lockable Recess Box	8736200270

Brick Opening Dimensions	
Height	930mm
Width	345mm
Depth	145mm

*Minimum Dimensions

Controllers – for all OptiFlow models

Note: OptiFlow Controllers are each supplied with a 20m cable. Any combination of bathroom and main controllers can be used, however at least one main controller must be used if a set temperature above 50°C is required.



Main Controller (Part no: 7736504469)

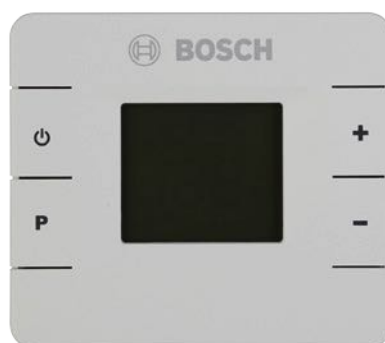

Bathroom Controller (Part no: 7736504467)



OptiFlow Professional Internal

Features & Benefits

- ▶ Room-sealed appliance
- ▶ Inbuilt temperature controller
- ▶ Electronically controlled modulation
- ▶ 6 Star efficiency
- ▶ Solar compatible water heater
- ▶ 50°C compliant models available
- ▶ Approved Bosch OptiFlow fluing must be used
- ▶ 3 year parts and labour warranty
- ▶ 12 year heat exchanger warranty (part only)

Specifications		Model		
	Unit	12L	16L	20L
Technical features				
Bluetooth Enabled Appliance		No		
Star Rating		6 Stars		
Solar Compatible		Yes		
Temperature Controllers		1 temperature controller		
Maximum Temperature		Preset at 55°C. Adjustable to 60°C and 70°C		
50°C compliant models available		Yes		
Weight (unpacked)	kg	10	11	12
Frost protection included		Yes		
Gas supply data				
Maximum Nominal Gas Consumption	Mj/h	90	120	149
Minimum Gas Supply Pressure - NG (in operation)	kPa	1.13		
Minimum Gas Supply Pressure - LPG (in operation)	kPa	2.75		
Water Supply Data				
Maximum Permissible Pressure (static)	kPa	1000		
Minimum Operating Pressure	kPa	100		
Minimum Operating Pressure for Max. Performance	kPa	200		
Minimum Water Flow	l/min	2.0		
L/min at 25°C Temperature Rise	l/min	12	16	20
Maximum Inlet Temperature	°C	80		
Electrical Circuit				
Power Supply Voltage	Vac	230 / 240		
Frequency	Hz	50		
Maximum Power - Frost Protection	W	165		
Maximum Power - Normal Operation	W	40	40	50
Warranty Details (Domestic)				
Parts and Labour	Years	3		
Heat Exchanger (part only)	Years	12		
Pipe Connection Sizes				
Gas Connection - NG or LPG	mm	15mm		
Cold Water	mm	15mm		
Hot Water	mm	15mm		

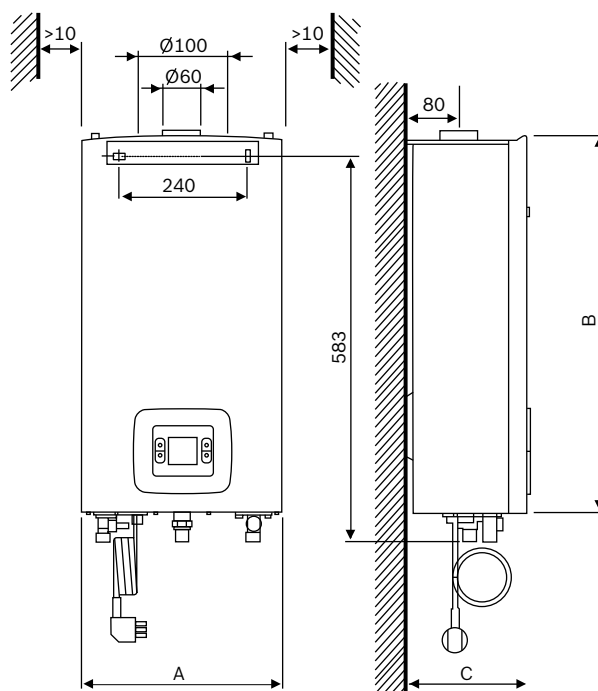

Measurements (mm)	A	B	C
12L model	300	570	170
16L model	364	570	175
20L model	364	570	175

Description	Part Number
OptiFlow Professional 12L NG	7736502487
OptiFlow Professional 12L LPG	7736502488
OptiFlow Professional 12L 50°C compliant NG	7736502489
OptiFlow Professional 12L 50°C compliant LPG	7736502490
OptiFlow Professional 16L NG	7736502495
OptiFlow Professional 16L LPG	7736502496
OptiFlow Professional 16L 50°C compliant NG	7736502497
OptiFlow Professional 16L 50°C compliant LPG	7736502498
OptiFlow Professional 20L NG	7736502499
OptiFlow Professional 20L LPG	7736502500
OptiFlow Professional 20L 50°C compliant NG	7736502501
OptiFlow Professional 20L 50°C compliant LPG	7736502502

OptiFlow Accessories

Which type of flue to use

OptiFlow Professional Internal flue must be used with these appliances. Any installations with the incorrect flue will not be approved and could pose a risk. The flue used for the OptiFlow Professional Internal is a 60/100 Ø coaxial flue. This flue allows the appliance to draw air in from outside, and expel flue gas back outside, making the appliance room sealed.

The flue materials used

Inner and outer layers are extruded aluminium. The outer layer is painted white.

Cutting the flue to length

Flue extensions can be cut to length. Care should be taken to remove burrs to maintain the integrity of the seal to the adjoining fitting.

Straight Flue Length Table

	12/16L	20L
Maximum vertical flue length	12m	10m
Maximum horizontal flue length	8m	6m

Reduction in lengths for bends

For every bend added to a flue configuration, the maximum acceptable flue length will reduce by the amount shown.

Flue Bend reduction Table

45° Bend	1m
90° Bend	2m

Condensate Traps

Condensate is more likely to form in longer lengths of flue, or when the outside ambient air temperature is low. The table below shows the length and temperature combinations when a condensate trap should be used. Condensate trap kits are supplied with all components required for installation.

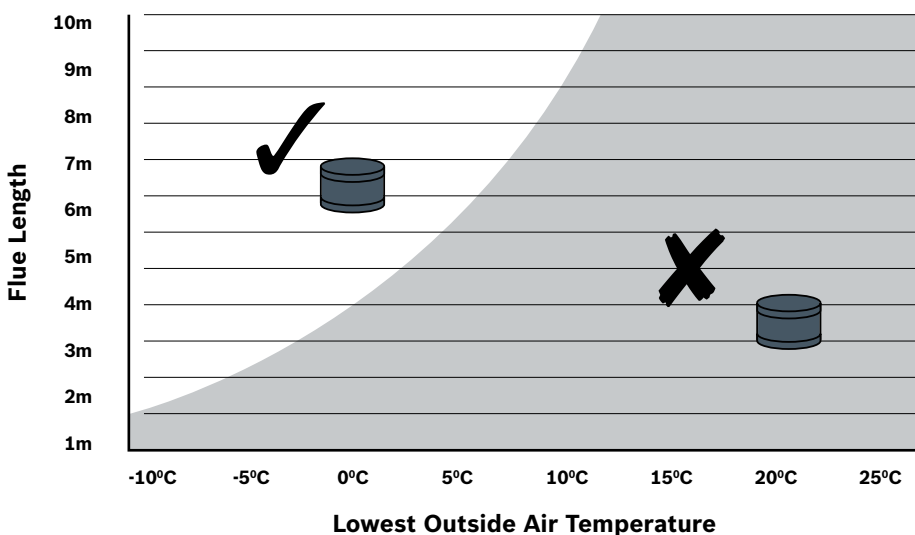

Selecting the Right Flue

- 1 Map your flue configuration.
- 2 Check that the configuration, including bends, is within the maximum flue length limits.
- 3 Calculate whether a condensate trap is required using the table on page 9.
- 4 Choose the flue kit that best suits your application.
(The kit includes the appliance adaptor and terminal.)
- 5 Add any flue lengths, bends, or condensate traps required for your configuration.
- 6 Place your order using the Bosch part numbers shown below.

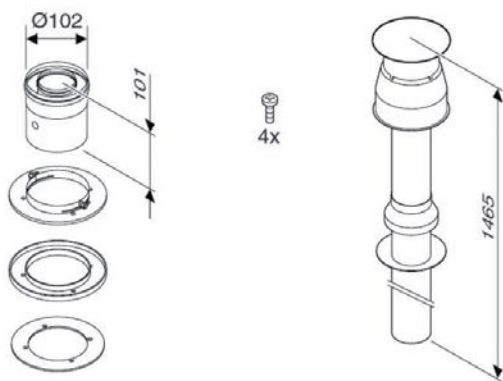

Vertical Flue Kit

Part No: 7716050071

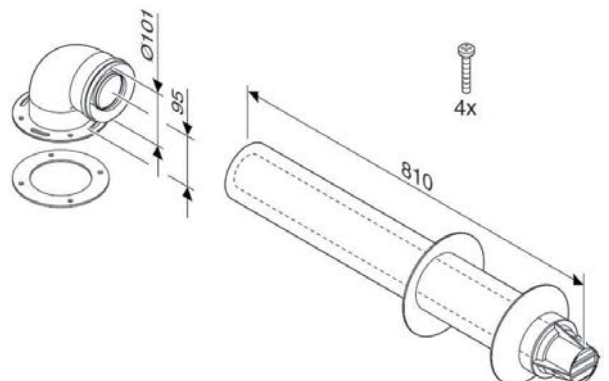
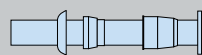

Fixed Length Horizontal Flue Kit

Part No: 7716050064

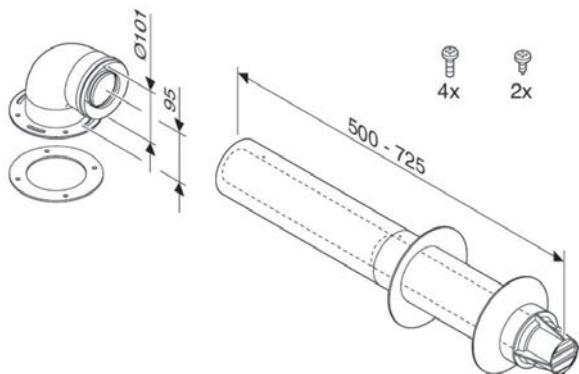

Telescopic Horizontal Flue Kit

Part No: 7716050063

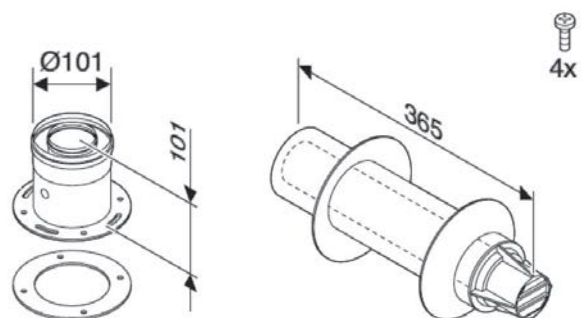

Highline Horizontal Flue Kit

Part No: 7736995083



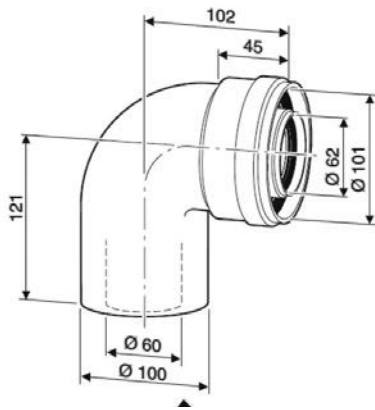

90° elbow

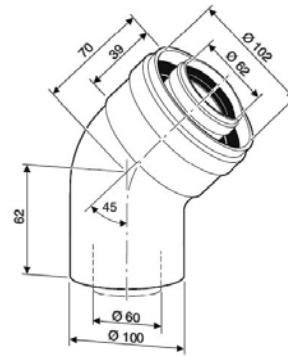
Part No: 7736995079

45° elbow

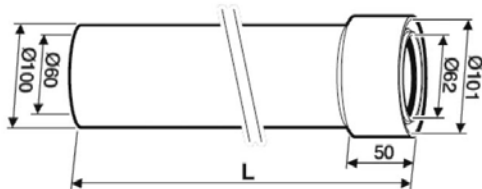
Part No: 7736995071

Straight Pipe 350 mm

Part No: 7736995059

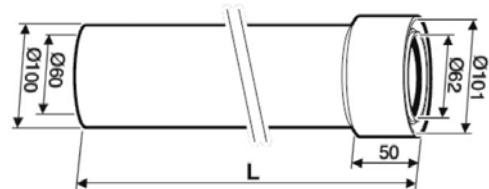
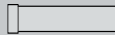
Straight Pipe 750 mm

Part No: 7736995063

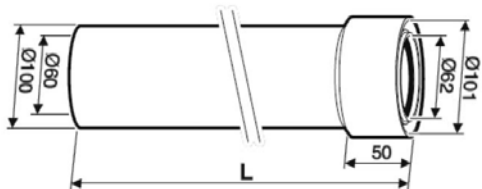
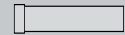
Straight Pipe 1500 mm

Part No: 7736995067

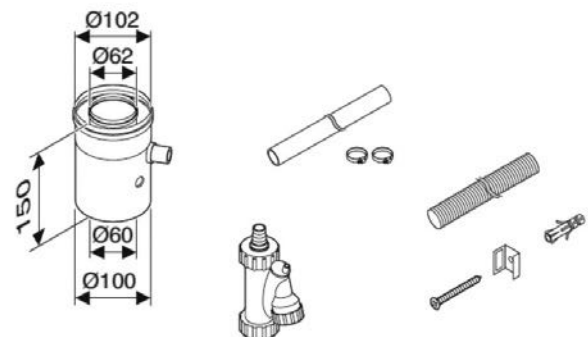
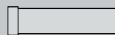

Horizontal Condensate Collector

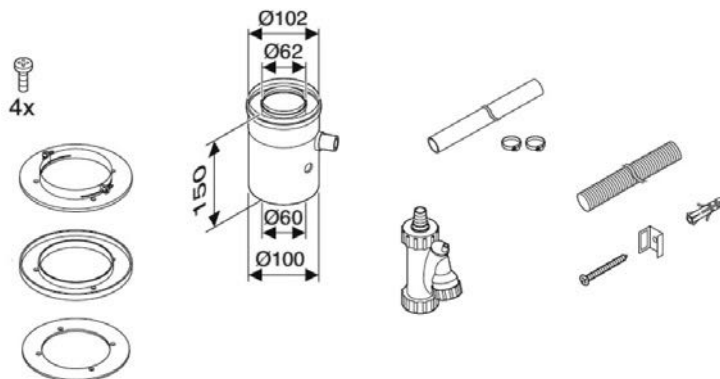
Part No: 7736995087

Vertical Condensate Collector

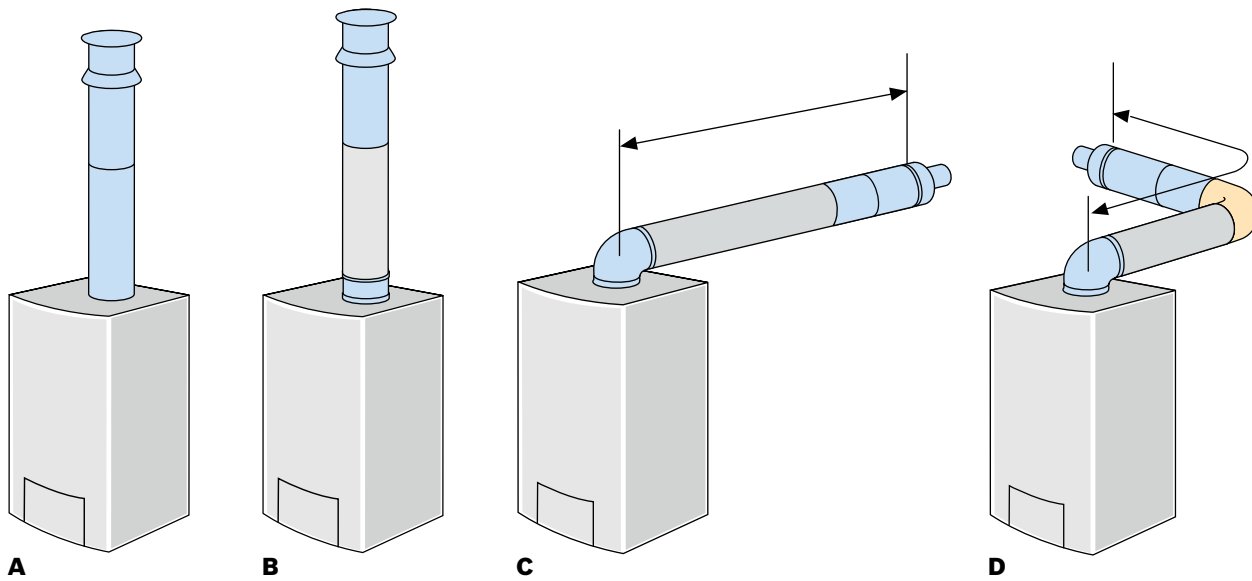

Part No: 7736995089

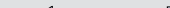

**A Standard vertical flue – Minimum length**

Components		
Part Numbers	7716050071	
Number of components required		
Ø60/100	1.4m	1



B Standard vertical flue

Components				
Part Numbers		7716050071	7736995059 (350mm) 7736995063 (750mm) 7736995067 (1500mm)	7736995089
Maximum length and number of components required				
Ø60 / 100	12m (12/16L) 8m (20L)	1	Up to 10.6m (12/16L) Up to 8.6m (20L)	1 (if required)

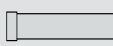
C Standard horizontal flue assembly



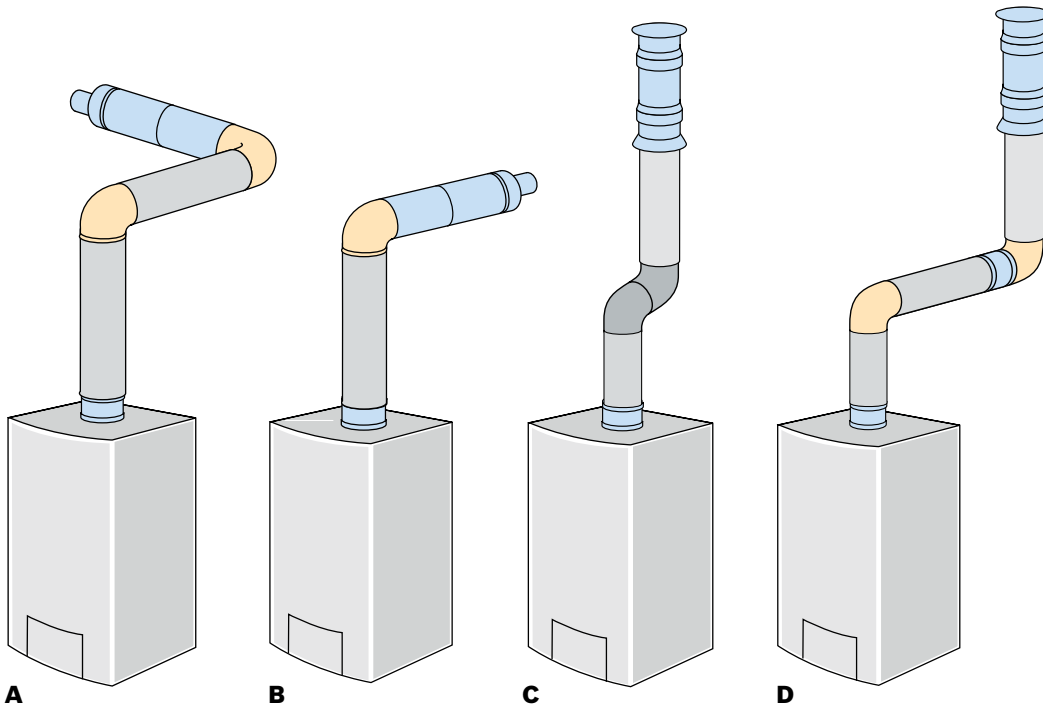

Components			
Part Numbers		7716050064 (fixed length kit) or 7716050063 (telescopic kit)	7736995059 (350mm) 7736995063 (750mm) 7736995067 (1500mm)
Maximum length and number of components required			
Ø60/100	10m (12/16L) 6m (20L)	1	Up to 9.5m (12/16L) Up to 5.5m (20L)

D Standard horizontal flue assembly with 90°



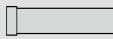

Components				
Part Numbers		7716050064 (Fixed length kit) or 7716050063 (Telescopic kit)	7736995079	7736995059 (350mm) 7736995063 (750mm) 7736995067 (1500mm)
Maximum length and number of components required				
Ø60 / 100	8m (12/16L) 4m (20L)	1	1	Up to 7.5m (12/16L) Up to 3.5m (20L)





A Extension flue horizontal and upwards

Components					
Part Numbers		7736995083	7736995079	7736995059 (350mm) 7736995063 (750mm) 7736995067 (1500mm)	7736995089
Maximum length and number of components required					
Ø60 / 100	8m (12/16L) 4m (20L)	1	2	Up to 7.5m (12/16L) Up to 3.5m (20L)	1 (if required)



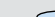

B Extension flue horizontal and upwards

Components					
Part Numbers		7736995083	7736995079	7736995059 (350mm) 7736995063 (750mm) 7736995067 (1500mm)	7736995089
Maximum length and number of components required					
Ø60 / 100	10m (12/16L) 6m (20L)	1	1	Up to 9.5m (12/16L) Up to 5.5m (20L)	1 (if required)

C Vertical flue – two 45° bends

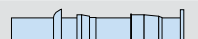
Components					
Part Numbers		7716050071	7736995071	7736995059 (350mm) 7736995063 (750mm) 7736995067 (1500mm)	7736995089
Maximum length and number of components required					
Ø60/100	10m (12/16L) 6m (20L)	1	1 (2 x bends per pack)	Up to 8.6m (12/16L) Up to 4.6m (20L)	1 (if required)

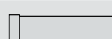
D Vertical flue – two 90° bends

Components						
Part Numbers		771650071	7736995079	7736995059 (350mm) 7736995063 (750mm) 7736995067 (1500mm)	7736995087	7736995089
Maximum length and number of components required						
Ø60 / 100	8m (12/16L) 4m (20L)	1	2	Up to 7.5m (12/16L) Up to 3.5m (20L)	1 (if required)	1 (if required)



HighFlow Condensing

Features & Benefits

- ▶ 6 Star efficiency
- ▶ Saves 12% against equivalent non-condensing models
- ▶ Continuous flow technology
- ▶ Up to 4 temperature controllers
- ▶ Compact, lightweight design
- ▶ 3 year parts and labour warranty
- ▶ 10 year heat exchanger warranty (part only)

Specifications	Unit	C21		C26	
		NG	LPG	NG	LPG
Energy Star Rating		6.9	6.9	6.7	6.7
Operating Pressure	kPa	200 - 1000 kPa			
Minimum flow rate (at 20°C inlet temp)	L/min	2.5 L/min			
Weight	kg	17		18	
Maximum inlet water temperature	°C	50°C		50°C	
Frost protection included		Yes			
Connection Sizes					
Water inlet	mm	R ¾ (20mm)			
Power Supply					
Power Supply		230/240 VAC (50Hz)			
Power Consumption - Standard	W	40.6W		46.8W	
Power Consumption - Anti Freeze	W	130W			
Gas					
Maximum Gas Consumption	Mj/hr	145	149	175	185
Capacity					
Maximum Hot Water Capacity	25°C rise	21 L/min		26 L/min	
Accessories					
Maximum number of controllers		4		4	

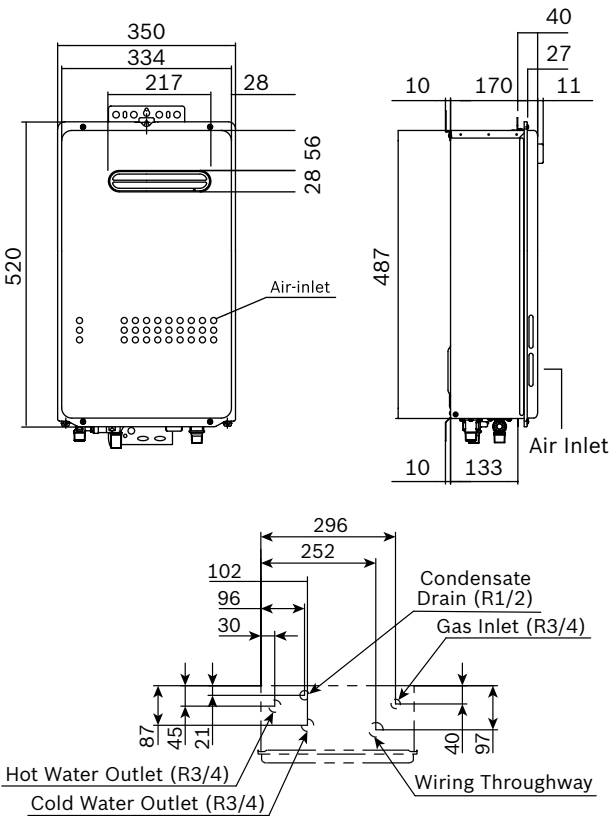

Description	Bosch Part Number
Bosch Condensing 21L 55°C NG	BC2180RANG
Bosch Condensing 21L 55°C LPG	BC2180RALP
Bosch Condensing 21L 50°C Compliant NG	BC2180RA5NG
Bosch Condensing 21L 50°C Compliant LPG	BC2180RA5LP
Bosch Condensing 26L 55°C NG	BC2680RANG
Bosch Condensing 26L 55°C LPG	BC2680RALP
Bosch Condensing 26L 50°C Compliant NG	BC2680RA5NG
Bosch Condensing 26L 50°C Compliant LPG	BC2680RA5LP

HighFlow Condensing Accessories

Recess box – for Highflow Condensing C21 & C26 models

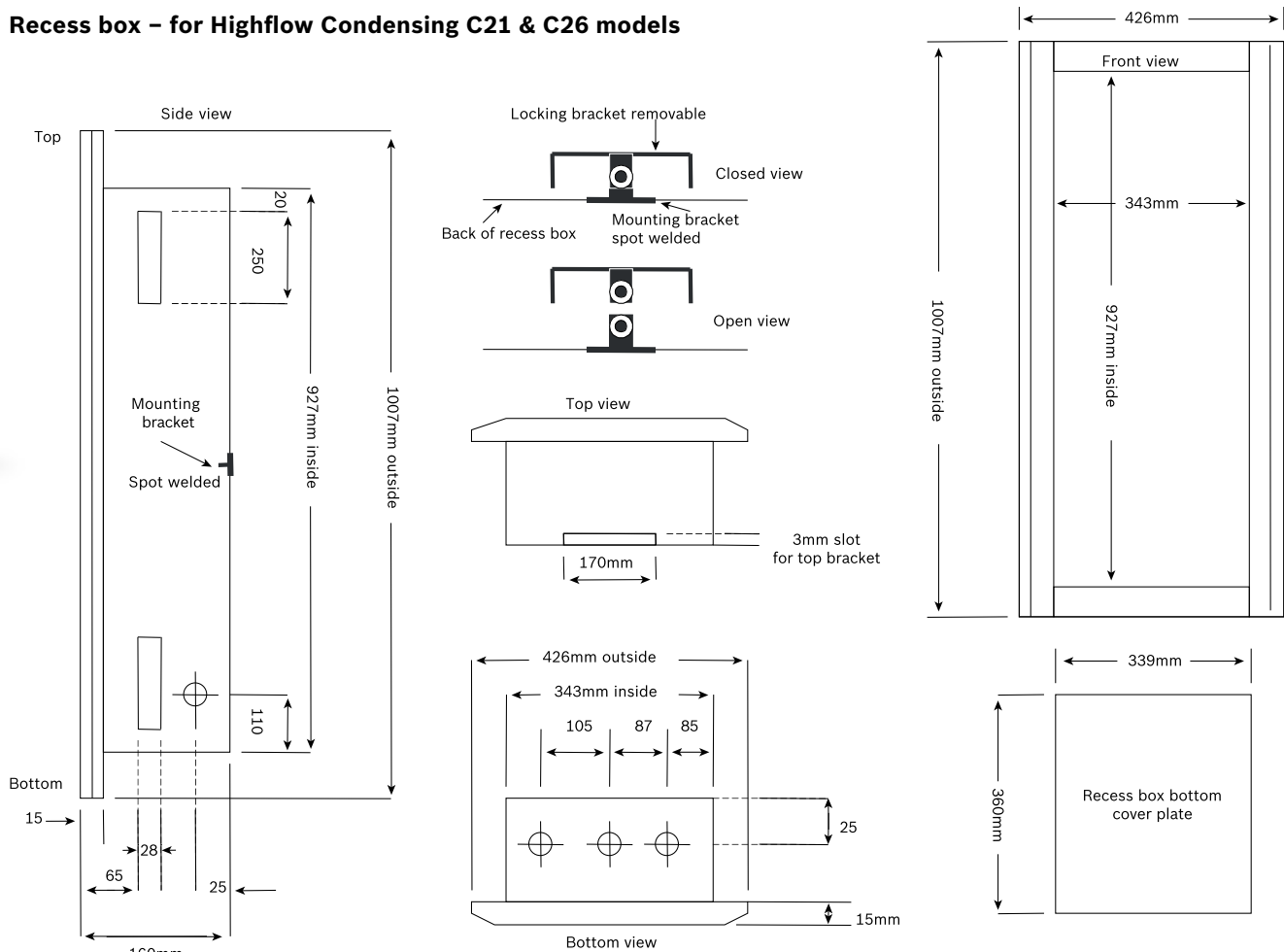

Description	Part Number
Lockable Recess Box	RBHF50L
Project Recess Box	PRB50L

Brick Opening Dimensions	
Height	930mm
Width	345mm
Depth	145mm

*Minimum Dimensions

HighFlow Condensing Controllers

Suitable for Highflow C21 & C26 models. Note: Each supplied with a 10m cable. A Main Controller must be installed as the first controller so that the maximum temperature can be reached. The bathroom controller has a maximum temperature of 50°C, as do the Sub Controllers which can be used as the third & forth controller.



Main Controller (Part no: YPRM67XBN)



Bathroom Controller (Part no: YPRS67XBN)



Sub Controller (Part no: YPRP62XBN)



HydroPower

Features & Benefits

- ▶ HydroPower ignition – no electricity supply required
- ▶ Continuous flow technology – heats only when required
- ▶ Constant, reliable source of hot water
- ▶ Energy efficient
- ▶ External installation
- ▶ 2 year parts and labour warranty
- ▶ 10 year heat exchanger warranty (part only)

Specifications	Model		
	Bosch 10H	Bosch 13H	Bosch 16H
Part Number	TF250-8G	TF325-8G	TF400-8G
Installation	External		
Ignition	Hydro		
L/min at 25°C Temperature Rise	10	13	16
Number of bathrooms	1	1	1-2
Min. inlet water pressure (kPa)	30	40	50
Min. constant water pressure for Max. flow (kPa)	60	100	130
Max. inlet water pressure (kPa)	800	800	800
Max gas consumption MJ/H	79	104	130
Star Rating	5.3	5.2	5.0
Min. Flow (L/min)	3.5	3.5	3.5
Gas Type	NG/LPG	NG/LPG	NG/LPG
Unit Height (mm)	845	845	936
Unit Width (mm)	405	405	460
Unit Depth (mm)	265	265	265
Carton Weight (Kg)	21	22	25
Domestic Warranty			
Parts and Labour	2 Years		
Heat Exchanger (part only)	10 Years		
Pipe Connection Size			
Natural gas (NG)	20 mm		
LP gas	15 mm		
Cold Water	15 mm		
Hot Water	15 mm		

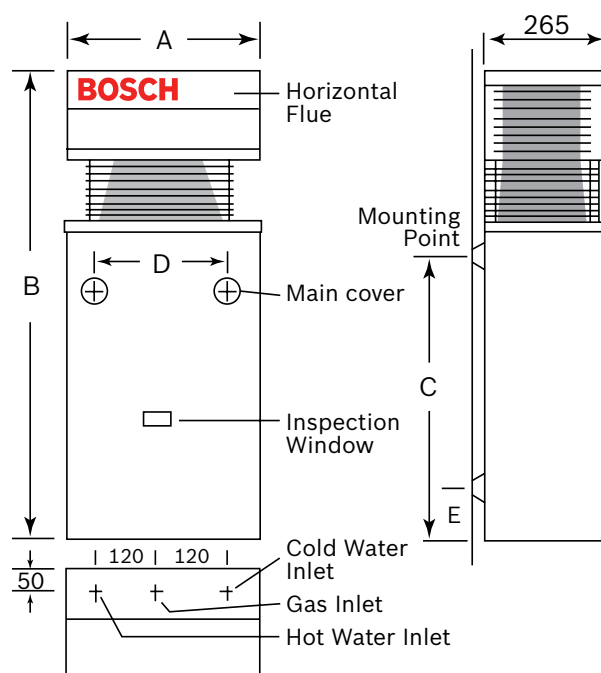

Dimensions			
	10H (mm)	13H (mm)	16H (mm)
A	405	405	460
B	845	845	936
C	533	533	533
D	240	240	240
E	68	68	82

Description	Bosch Part Number
Bosch 10H External NG	TF250-8GNG
Bosch 10H External LPG	TF250-8GLP
Bosch 13H External NG	TF325-8GNG
Bosch 13H External LPG	TF325-8GLP
Bosch 16H External NG	TF400-8GNG
Bosch 16H External LPG	TF400-8GLP



Pilot

Features & Benefits

- ▶ Economical running costs
- ▶ Continuous hot water
- ▶ Environmentally friendly
- ▶ Compact design – smaller than traditional storage water heaters
- ▶ External installation
- ▶ 2 year parts and labour warranty.
- ▶ 10 year heat exchanger warranty (part only)

Specifications	Model		
	Unit	Bosch 10P	Bosch 16P
Part Number		TF250	TF400
Installation	External		
Ignition	Standing Pilot		
L/min	25°C rise	10	16
Number of bathrooms		1	1-2
Min. inlet water pressure	kPa	30	50
Min. constant water pressure for Max. flow	kPa	90 (NG)	150
Max. inlet water pressure	kPa	1200	1200
Max gas consumption	Mj/H	82	130
Star Rating		4.6	4.3
Min. Flow	L/min	5.0	2.0
Gas Type		NG/LPG	NG
Unit Height	mm	845	936
Unit Width	mm	405	460
Unit Depth	mm	265	265
Carton Weight	kg	21	25
Domestic Warranty			
Parts and Labour	Years	2	
Heat Exchanger (part only)	Years	10	
Pipe Connection Size			
Natural gas (NG)	20 mm		
LP gas	15 mm		
Cold Water	15 mm		
Hot Water	15 mm		

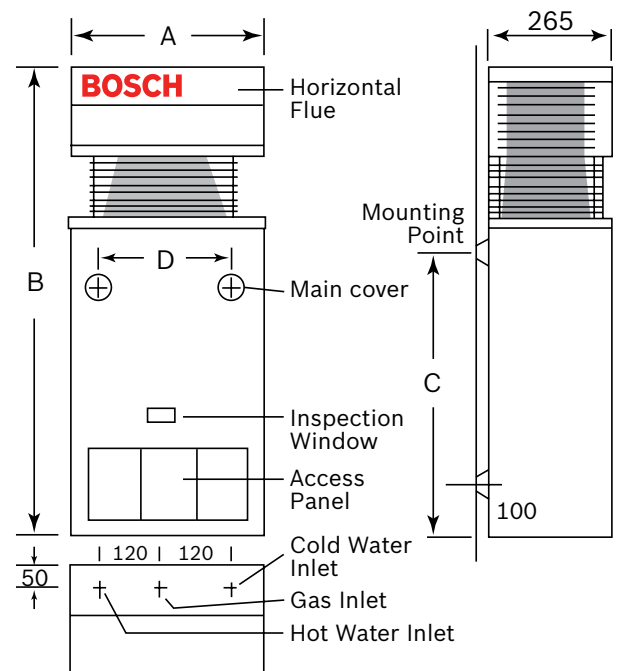

Dimensions		
	10P (mm)	16P (mm)
A	405	460
B	845	936
C	535	550
D	240	240

Description	Bosch Part Number
Bosch 10P External NG	TF250NG1TH
Bosch 10P External LPG	TF250LP3TH
Bosch 16P External NG	TF400NG1TR



Internal Compact

Features & Benefits

- ▶ Automatic ignition
- ▶ Internal installation (vertical flueing required) making it perfect for frost prone areas
- ▶ Improved safety features to provide reassurance for your family
- ▶ Flexible water connections for easy installation
- ▶ Small, compact and attractive design making it ideal for small homes where space is limited
- ▶ Lower flow rate available which allows water to be heated when only a small amount of water is being consumed
- ▶ Digital temperature display and user friendly controls
- ▶ 2 year parts and labour warranty
- ▶ 10 year heat exchanger warranty (part only)

Specifications	Model		
	Ci10	Ci13	Ci16
Part Number	GWH10-2G	GWH13-2G	GWH16-2G
Installation	Internal	Internal	Internal
Ignition	Automatic	Automatic	Automatic
L/min at 25°C Temperature Rise	10	13	16
No. of bathrooms	1	1	1-2
Min. inlet water pressure (kPa)	50	50	50
Min. constant water pressure for Max. flow (kPa)	100	140	170
Max. inlet water pressure (kPa)	1000	1000	1000
Mj/H	79	100 NG / 97 LP	127
Star Rating	5.3	4.5	4.6
Min. Flow (L/min)	2.5	2.5	2.5
Gas Type	NG/LPG	NG/LPG	NG/LPG
Unit Height (mm)	580	655	655
Unit Width (mm)	310	350	425
Unit Depth (mm)	220	220	220
Dry Weight (Kg)	10.2	11.8	13.65
Flue Pipe Sizes (mm)	100	125	125
Domestic Warranty			
Parts and Labour	2 Years		
Heat Exchanger (part only)	10 Years		
Pipe Connection Size			
Natural gas (NG)	20 mm		
LP gas	15 mm		
Cold Water	15 mm		
Hot Water	15 mm		

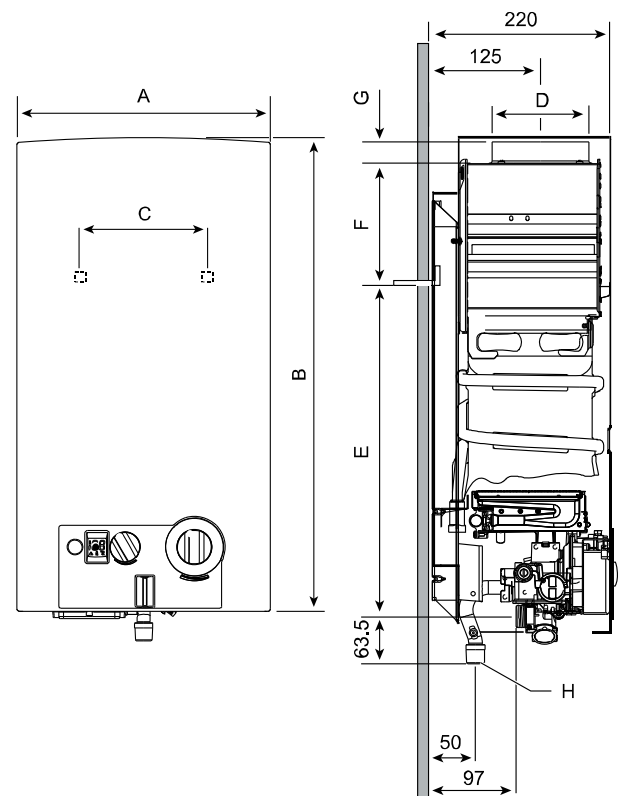

Dimensions			
	Ci10 (mm)	Ci13 (mm)	Ci16 (mm)
A	310	350	425
B	580	655	655
C	228	228	334
D	115	140	140
E	463	510	540
F	60	95	65
G	25	30	30

Description	Bosch Part Number
Bosch Ci10 Internal NG	GWH10-2GNG
Bosch Ci10 Internal LPG	GWH10-2GLP
Bosch Ci13 Internal NG	GWH13-2GNG
Bosch Ci13 Internal LPG	GWH13-2GLP
Bosch Ci16 Internal NG	GWH16-2GNG
Bosch Ci16 Internal LPG	GWH16-2GLP



Compress 3000

Features & Benefits

- ▶ Highly efficient heat pump – reduces energy by up to 65%*
- ▶ Eligible for generous government rebates***
- ▶ Smart Controls to take advantage of:
 - ▶ Cheaper overnight power prices
 - ▶ PV Solar energy generation systems
 - ▶ Noise reduction mode
- ▶ Designed for easy and low-cost installation and servicing
- ▶ The heat pump operates from -7°C to +40°C, delivering energy efficient hot water even in colder climates

	Model	
	Unit	270L
Part Number	7736501960	
Code for REC Registry (STCs)	HP 270-2E 0 F00VIS	
Specifications		
HeatPump operating temperatures	°C	-7 to 40
Complete appliance operating temperatures	°C	-10 to 40
Outlet Water Temperature	°C	37 to 65
Outlet water set temperature range	°C	37 to 60
Storage capacity (L)	L	270
Hot water delivery at °40C	L	335 ± 20
Max water relief pressure	kPa	1000
Max water relief pressure	kPa	800
COP**		3.3
Heat Pump Module		
Max power input	kW	0.6
Max current	A	2.6
Heat pump heating capacity	kW	1.5
Back Up Electric Element		
Maximum power input	kW	1.65
Total maximum current	A	7.2
Appliance Total		
Maximum heating capacity	kW	3.15
Maximum power input	kW	2.25
Maximum current	A	9.8
Product Dimensions		
Net empty weight	kg	130
Refrigeratiuon type / mass	kg	R134a / 0.375
Domestic Warranty		
Parts & Labour	Years	2
Tank (part only)	Years	5

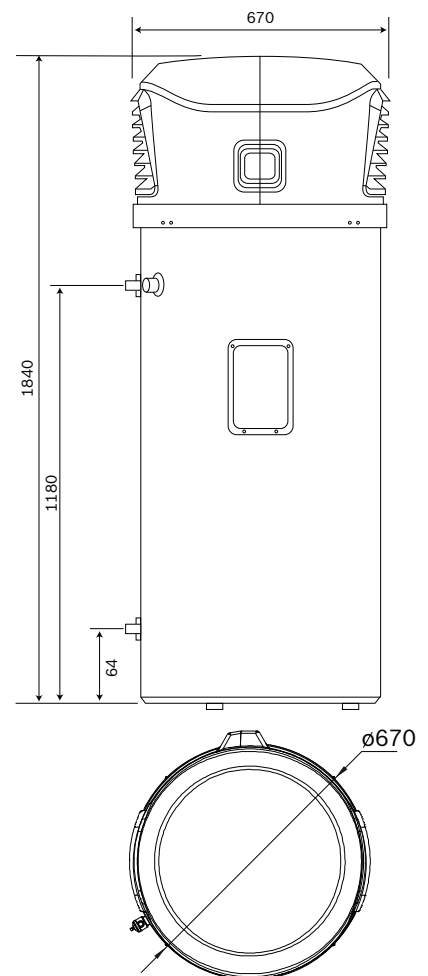

Note: Heat pumps use the ambient temperature in surrounding air to heat water in the tank. This means as the air temperature around the tank decreases, the time taken to heat the full tank increases. Customers in colder climates and frost prone areas should consider this when deciding which type of Bosch system is best for their circumstances.

* When compared with a conventional electric storage system.

** COP as measured under the following conditions:
air 15°C; RH 70%; water 15°C-60°C.

*** Postcodes for each of the STC zones are available on: ret.cleanenergyregulator.gov.au

Clearances

Heatpumps draw heat from the air surrounding the appliance. For this reason they must have sufficient clearance on both sides (at least 400mm) to allow air to pass through the appliance. Bosch also recommends that the a clearance of at least 50mm from the wall, and 600mm above the appliance is allowed so that components are easily accessible for servicing.

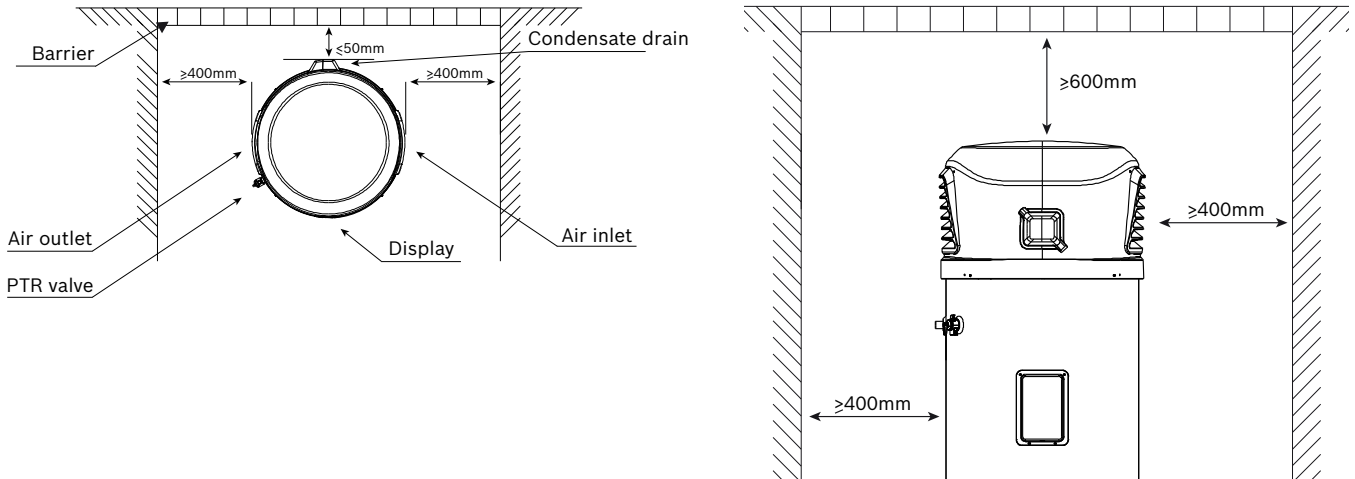

Heat pump module purge

During installation the water loop in the heat pump module must be purged to expel possible air locks. This process should be followed once the appliance has been connected to water lines and electricity, and the heat pumps tank has been filled.

- Step 1** Turn the appliance on at the electrical isolating switch. Program the date and time into the appliance.
- Step 2** Rotate the circulation pump speed selector to position “III”.
- Step 3** Make sure that appliance is in Manual (man) mode. Activate the Purge (Purg) function in the appliance controls. Press the “menu” button then use the ‘+’, ‘-’ and ‘ok’ buttons to select the Purge function using the following pathway: select “Set” -> select “Purg”. -> select “OK”
- Step 4** Open the brass bleed valve at the top of the water-loop inside the module (see fig 1) and allow water and bubbles to escape. Leave open for 30 to 60 seconds.
- Step 5** When no air bubbles are visible in the stream, close the brass bleed valve.
- Step 6** Open the purge screw on the side of the circulation pump (see fig 2) and leave open until water drains uniformly without air bubbles. Close the purge screw.
- Step 7** The Purge mode will continue to run for 5 mins. When complete, return the pump speed selector to position “I”.

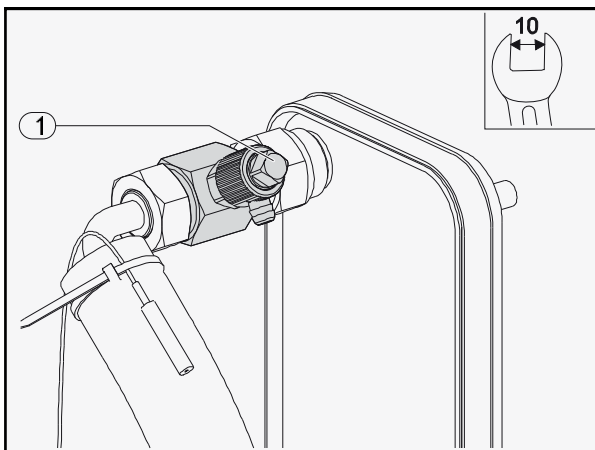

Figure 1

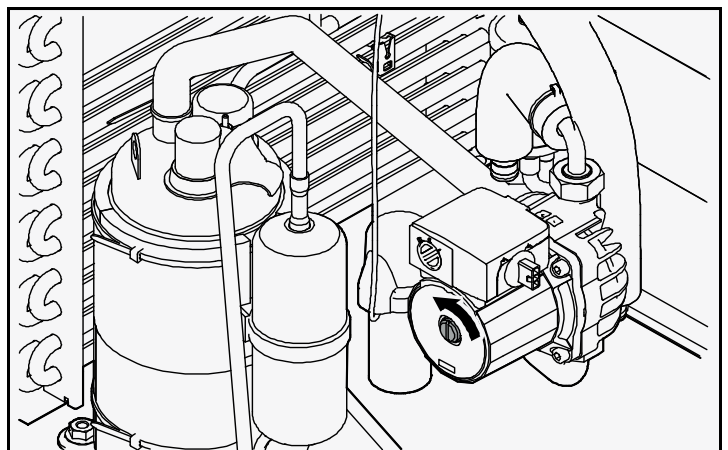

Figure 2

Warranty & Service Information



Warranty

The OptiFlow models are covered by a comprehensive 3 year parts and labour warranty, and a 12 year heat exchanger (part only) warranty. The Bosch Highflow Condensing models are covered by a 3 year parts and labour, and a 10 year heat exchanger (part only) warranty. The Bosch HydroPower, Pilot and Internal Compact ranges are covered by a 2 year parts and labour warranty, and a 10 year (part only) warranty.

For a full copy of the Bosch Warranty Statement, please visit our website www.bosch-climate.com.au or call 1300 30 70 37.

Important note for Australian Consumers

Our goods come with guarantees that cannot be excluded under the Australian Consumer Law. You are entitled to a replacement or refund for a major failure and for compensation for any other reasonably foreseeable loss or damage. You are also entitled to

have the goods repaired or replaced if the goods fail to be of acceptable quality and the failure does not amount to a major failure.

Our extensive services agent network and support staff are available across Australia to assist consumer with any queries.

Servicing

To ensure your appliance's quality and performance is optimised, Bosch recommends having your unit serviced no less than once every 2 years. Having your product inspected and cleaned periodically by an authorised Bosch service technician not only ensures peak operation but also extends the life of the appliance.

For contact details of your nearest service agent within Australia please phone our Customer Contact Centre on 1300 30 70 37.

Bosch e-Learning Program



Bosch Hot Water and Heating has introduced a new and exciting initiative for providing training for people involved in the sales, installation, and service of hot water products.

The e-Learning system provides a comprehensive training solution where you can:

- ▶ book into face to face training courses
- ▶ participate in e-Learning courses
- ▶ download technical and spare parts information.

The e-Learning Program is online and live which ensures you have the most up to date and current Bosch hot water and heating information.

We welcome you to our community and encourage you to explore our system by visiting:
www.boschhotwatertraining.com.au

Notes

[illegible]



Robert Bosch Australia Pty. Ltd.

1555 Centre Rd
Clayton Victoria 3168
Sales Hotline: 1300 30 70 37
Sales Fax: 1300 30 70 38

bosch-climate.com.au

Technical data subject to modification without notice.

Printed in Australia. Any color variations are due to the limitations of the printing process.

Printed on 100% chlorine-free bleached cellulose manufactured in an environmentally friendly process.